



**ALL GLASS
PARTS INC**
HARDWARE - TOOLS - SUPPLIES

MINI POST WITH ADJUSTABLE ARM

Glass Balustrading
Carry max 45kg per 2 brackets

<http://www.allglassparts.com>

Note: This is informative material. Please verify with your engineer. For dimensions only, not to scale.

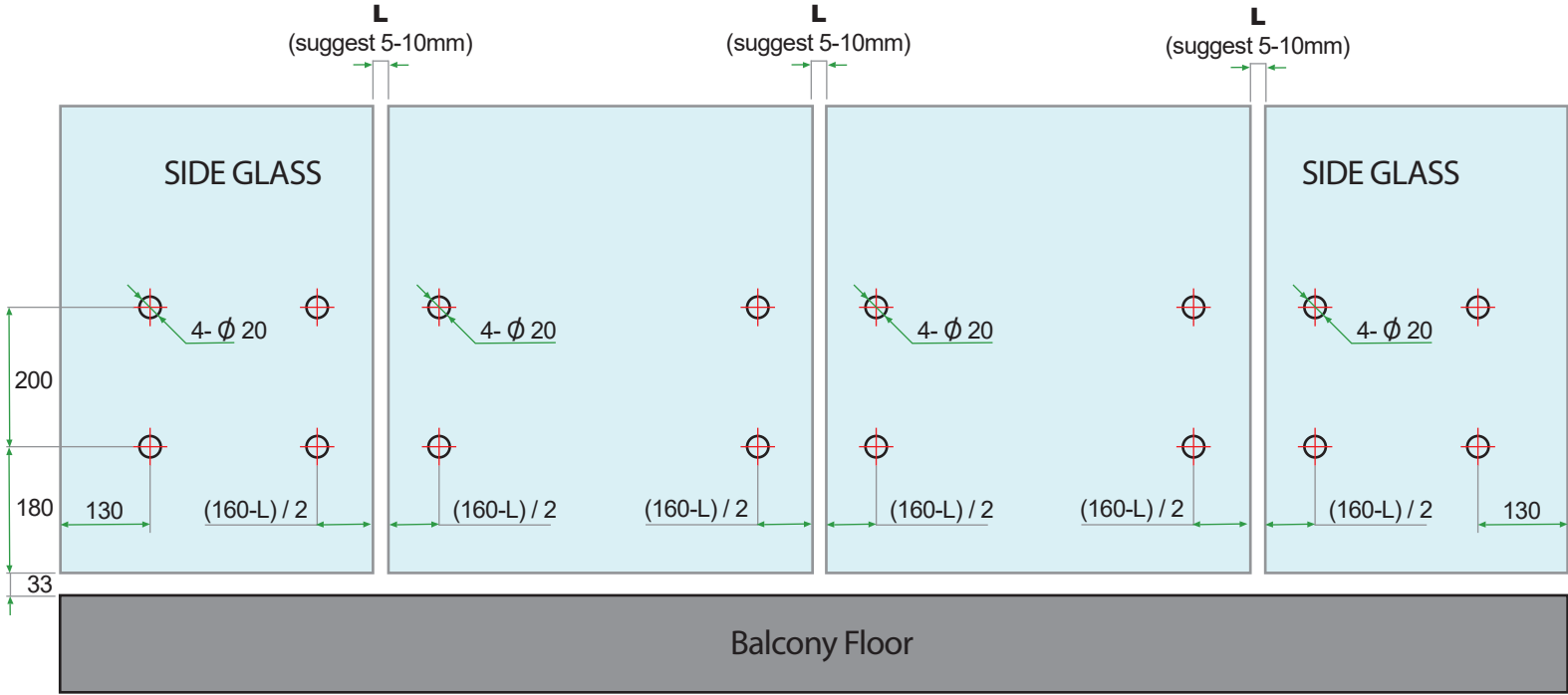

Installation steps:

Tools required for the installation.

- Level
- Tape Measure
- Soft Head Hammer
- Pencil
- Power Drill
- Allen Key
- Wrench
- Tool for Adjustable Arm

Important.

These instructions are for installation on concrete. Not recommended for treated wood. Spigots may oxidize

1. Using a level, mark a guide line across your floor where you intend to install your spigots.

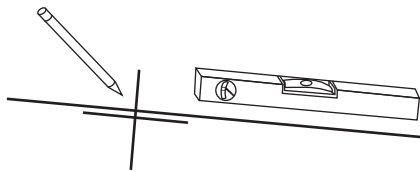

2. Drill each hole to a diameter of 12mm. Insert an anchor bolt into each hole

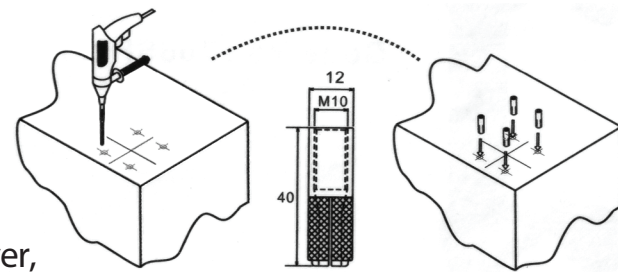

3. Lift up the decorative cover, tighten the Mounting screws

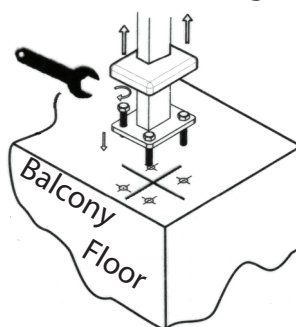



**ALL GLASS
PARTS INC**
HARDWARE - TOOLS - SUPPLIES

MINI POST WITH ADJUSTABLE ARM

Glass Balustrading
Carry max 45kg per 2 brackets

<http://www.allglassparts.com>

4. Put on the decorative cover, loosen the M10 screw to remove them. Loosen the adjustable screws a little to adjust the angle and height of the glass.

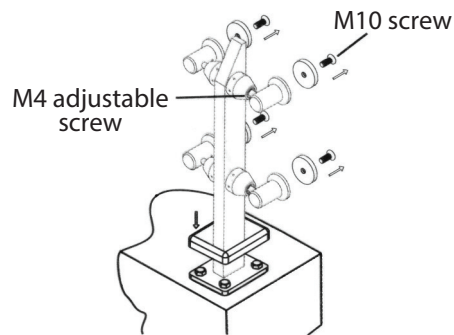

5. Installing the glass

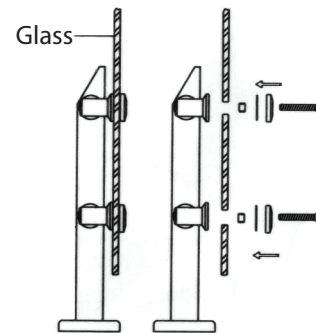

6. Adjusting the height and gap for the whole glass. Use the spanner to fasten the screw.

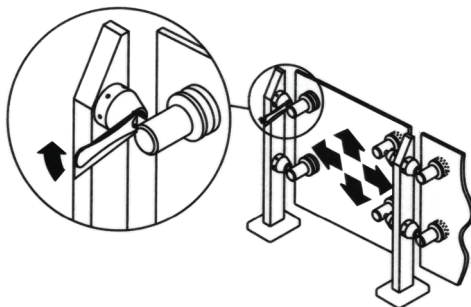

7. Installation complete. Fasten the M4 set screws after assembly

