

INSTRUCTIONS FOR REPLACING TILT PIN

TOOL LIST

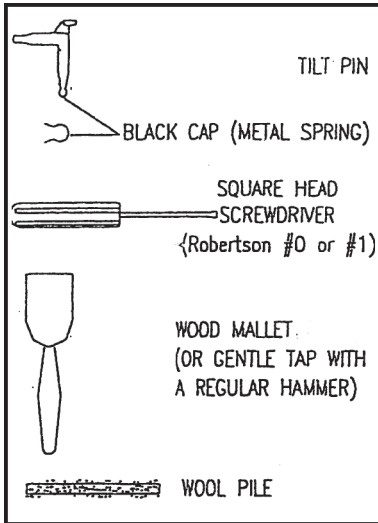

STEP 1. REMOVING THE TILT PIN

1. Place the screwdriver on to the tilt pin's black cap as shown on the picture below.
2. Tap on black cap with a screwdriver and wood mallet to flatten down the black cap.
3. This will help to remove tilt pin from profile.
4. Follow the same steps for both sides.

Tilt Pin
It's one end is in the side profile and the other end is in the bottom profile tilt pin has an "L" shape

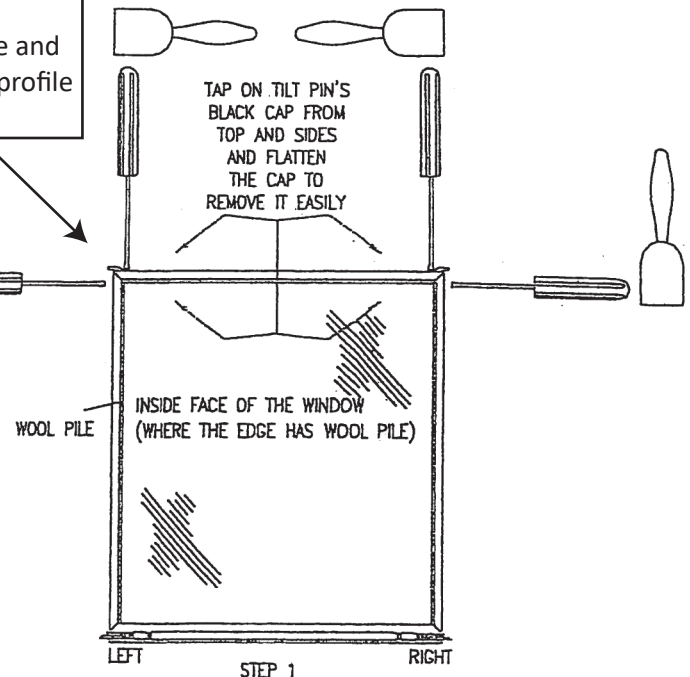

STEP 2.

1. Place screwdriver at the end of tilt pin as on picture below.
2. Tap tilt pin gently to up direction with a wood mallet (hammer) and a screwdriver.
3. Follow the same steps for both sides.
4. The profile will come out as on next picture (Step 3).

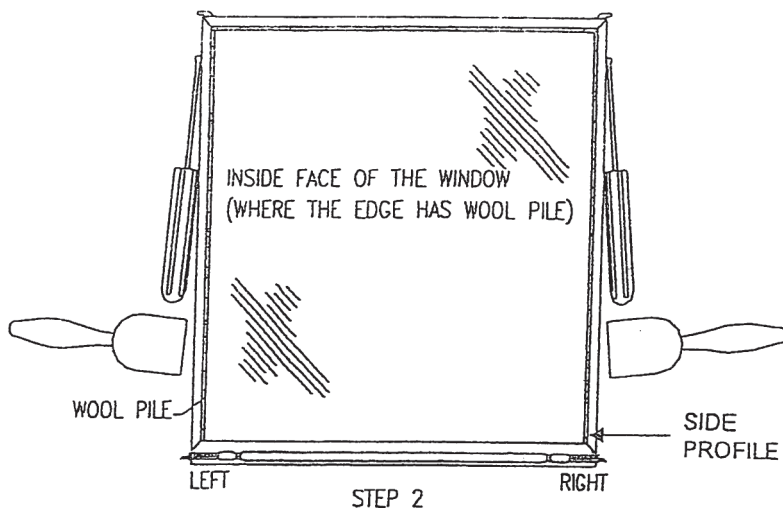

STEP 3.

1. Give it a strong tap to slide the sash lock out of the side profile. (You may work on floor and step your foot on the profile while you are hammering)
2. The spring will come out from the bottom profile.
3. Follow the same steps for both sides. (Step 3, Step 4)

STEP 3

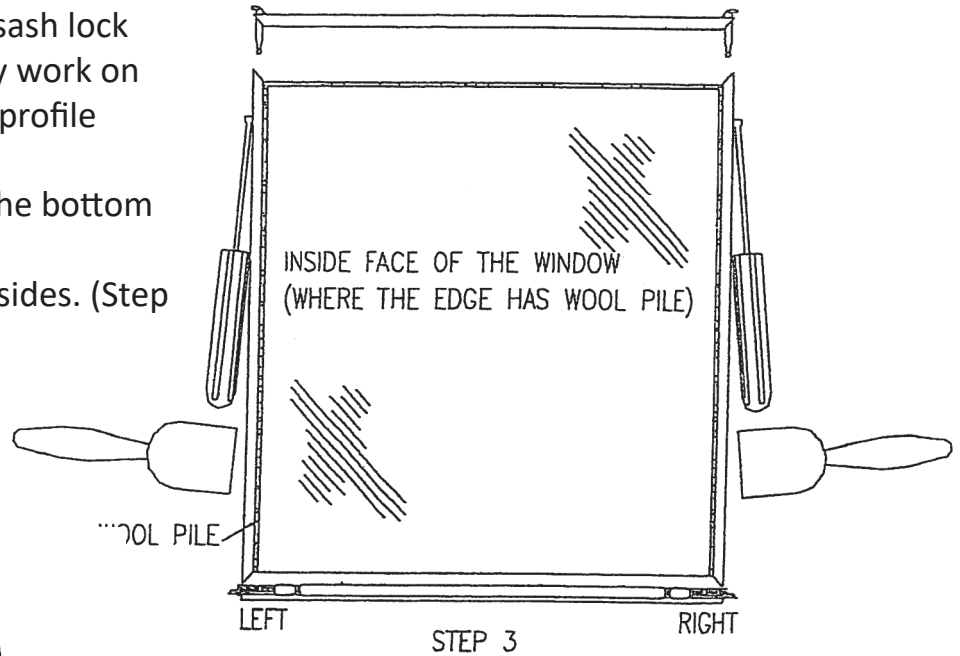
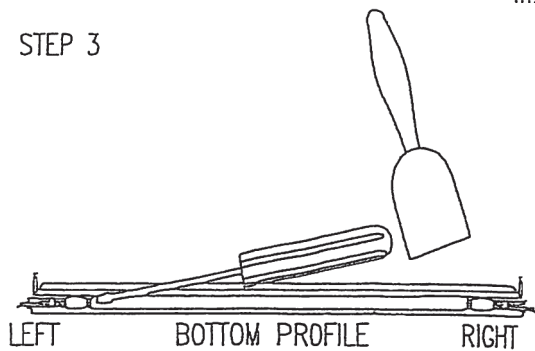

STEP 4

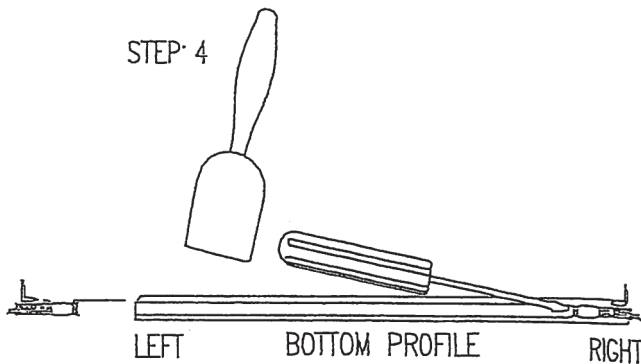

STEP 5



REPLACING THE NEW SASH LOCK

1. Replace the spring first. Make sure the spring is hooked to small nail on one side.
2. Replace the new sash lock. The red plastic extension on sash lock supposed to be facing you.
3. Slide the sash lock into bottom profile's large channel.
4. Make sure it is attached to the spring.
5. Place corner tilt pins into both profiles as shown at the picture below.
6. Follow the same steps for both sides.

Place the spring into the bottom profiles small channel where you previously removed the tilt pin and spring from.

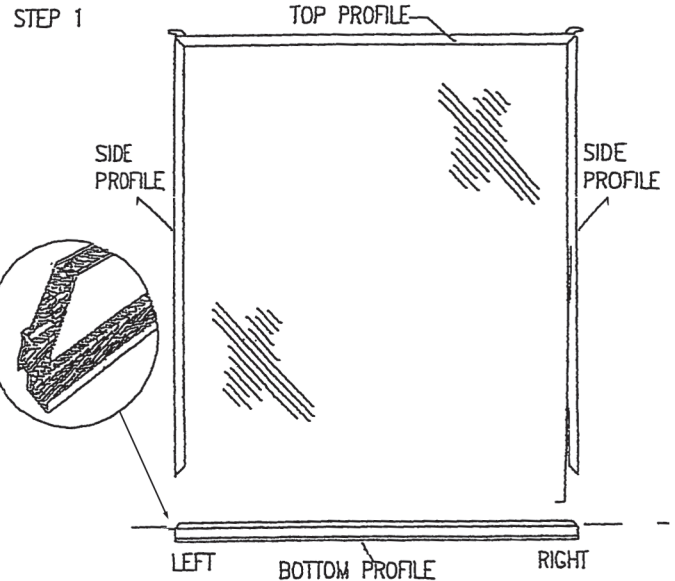

Place the sash lock into the bottom profile where you previously removed the damaged sashlock from.

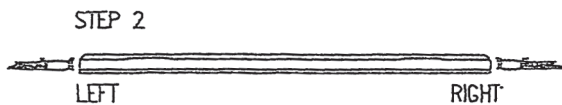

Replace the tilt pin into the bottom profile where you previously removed the tilt pin from gently tap from side of the tilt pin to make sure it sits into the profile tightly.

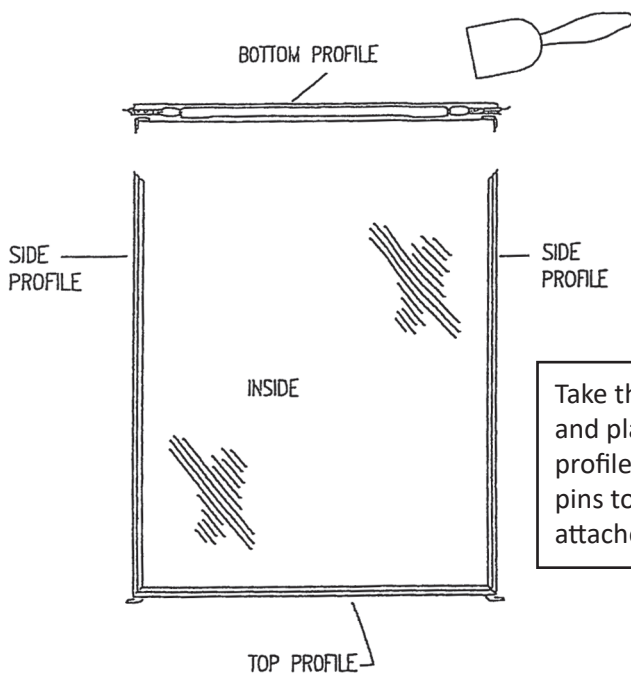
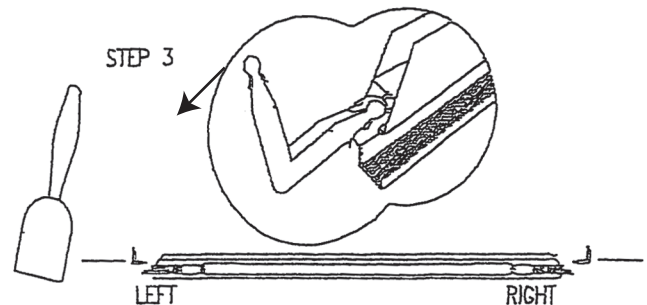

Take the existing frame. Rotate the bottom profile upside down and place it on each ends of the existing frame tap on bottom profile from its both top side corners to get it attached by its tilt pins to the existing frame. Make sure the bottom profile attached to the existing frame with no gap.